

Please Note:

- This is NOT for the New Energy Saver Swing Door Product
- This catalog is for *Product Produced 02/19/1996 & Prior*
AND
for Product Produced 02/19/1996 to 2004.

Table of Contents

Exploded View	158
Parts List	159
Sills, Thresholds and Stops	160 – 164
Glass Bead	165
Glass	166
Panel Assembly	167
Insulating Panel	167
Low-E Panel	167
Low-E Climate Control Panel	167
Low-E Super Sun Blocker Panel	167
Screens	168
Handle Packages	169
3-Point Hardware, Exploded View	170 – 171
3-Point Hardware, Prior to 11/2002	170
3-Point Hardware, Current	171
Handle Packages, 3-Point Hardware	172 – 173
Active Handle Packages	172
Semi-Active Handle Packages	172
Miscellaneous Options	173
Miscellaneous	174 - 178
Swing Patio Hardware	174
Fastener Schedule	175
Weatherstripping/Miscellaneous	178
Elevations	179 - 192

Hurd Classic Aluminum Wood Inswing Patio Doors

Windows and Doors Replacement Parts

Exploded View

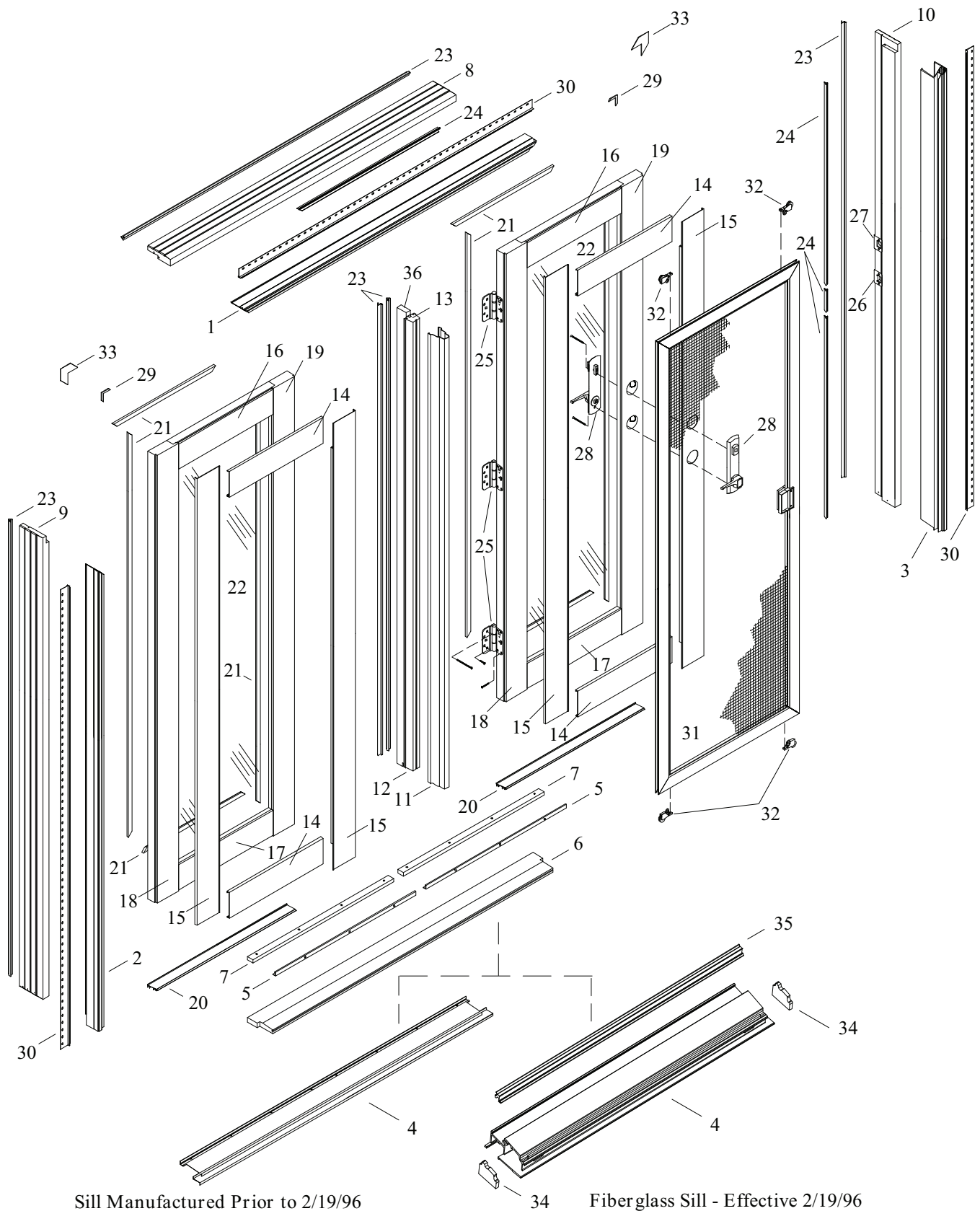

Sill Manufactured Prior to 2/19/96

Fiber glass Sill - Effective 2/19/96

Classic Aluminum Wood Inswing Patio Doors Replacement Parts



Parts List

Sill Manufactured Prior to 2/19/96

Item No.	Description
1.	Head Jamb Aluminum Frame Extrusion
2.	Left Side Jamb Aluminum Frame Extrusion
3.	Right Side Jamb Aluminum Frame Extrusion
4.	Aluminum Sill
5.	Aluminum Vertical Leg
6.	Non-Adjustable Subsill
7.	Oak Threshold
8.	Head Jamb
9.	Left Side Jamb
10.	Right Side Jamb
11.	Astragal (Mull) Jamb Aluminum Cap
12.	Astragal (Mull) Jamb
13.	Astragal (Mull) Cap
14.	Top and Bottom Rail Aluminum Cover
15.	Left and Right Stile Aluminum Cover
16.	Top Rail
17.	Bottom Rail
18.	Left Stile
19.	Right Stile
20.	Bottom Door Sweep
21.	Wood Interior Glazing Bead
22.	Glass
23.	Q-Lon Weatherstrip
24.	Leaf Weatherstrip-Latch Side and Head Jamb (Operator Side Only)
25.	Adjustable Hinge
26.	Strike Plate-Latch
27.	Strike Plate-Deadbolt
28.	Lockset-Standard
29.	Corner Keys
30.	Folding Nailing Fin
31.	Screen
32.	Screen Rollers
33.	Nailing Fin Corner Pads

Fiberglass Sill - Effective 2/19/96

Item No.	Description
1.	Head Jamb Aluminum Frame Extrusion
2.	Left Side Jamb Aluminum Frame Extrusion
3.	Right Side Jamb Aluminum Frame Extrusion
4.	Sill
5.	Aluminum Vertical Leg
6.	Non-Adjustable Subsill
7.	Oak Threshold
8.	Head Jamb
9.	Left Side Jamb
10.	Right Side Jamb
11.	Astragal (Mull) Jamb Aluminum Cap
12.	Astragal Mullion Cap
13.	Dual Astragal Cap
14.	Top and Bottom Rail Aluminum Cover
15.	Left and Right Stile Aluminum Cover
16.	Top Rail
17.	Bottom Rail
18.	Left Stile
19.	Right Stile
20.	Bottom Door Sweep
21.	Wood Interior Glazing Bead
22.	Glass
23.	Q-Lon Weatherstrip
24.	Leaf Weatherstrip-Latch Side and Head Jamb (Operator Side Only)
25.	Adjustable Hinge
26.	Strike Plate-Latch
27.	Strike Plate-Deadbolt
28.	Lockset-Standard
29.	Corner Keys
30.	Folding Nailing Fin
31.	Screen
32.	Screen Rollers
33.	Nailing Fin Corner Pads
34.	Sill Plug
35.	Sill Weatherstrip
36.	Hingeside Tongue Adj. Astragal

Sills, Thresholds and Stops

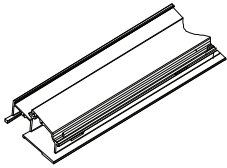

Item #4	Part No.
4-9/16 Fiberglass Sill (Effective 2/19/96)	
Single Wide	
1-4 Fiberglass Sill	016783
1-6 Fiberglass Sill	016784
1-8 Fiberglass Sill	016785
2-0 Fiberglass Sill	076719
2-6 Fiberglass Sill	076720
2-8 Fiberglass Sill	076721
3-0 Fiberglass Sill	076722
2 Wide	
2-0/2-0 Fiberglass Sill	076723
2-6/2-6 Fiberglass Sill	076724
2-8/2-8 Fiberglass Sill	076725
3-0/3-0 Fiberglass Sill	076726
3-0/1-4 Fiberglass Sill	076724
1-4/3-0 Fiberglass Sill	076724
3-0/1-6 Fiberglass Sill	076724
1-6/3-0 Fiberglass Sill	076724
3-0/1-8 Fiberglass Sill	076724
1-8/3-0 Fiberglass Sill	076724
3-0/2-0 Fiberglass Sill	076725
2-0/3-0 Fiberglass Sill	076725
3 Wide	
2-0/2-0/2-0 Fiberglass Sill	076726
2-6/2-6/2-6 Fiberglass Sill	076727
2-8/2-8/2-8 Fiberglass Sill	076728
3-0/3-0/3-0 Fiberglass Sill	076729
2-6/2-6/1-8 Fiberglass Sill	076727
1-8/2-6/2-6 Fiberglass Sill	076727
2-6/2-6/2-0 Fiberglass Sill	076727
2-0/2-6/2-6 Fiberglass Sill	076727
2-8/2-8/1-8 Fiberglass Sill	076727
1-8/2-8/2-8 Fiberglass Sill	076727
2-8/2-8/2-0 Fiberglass Sill	076727
2-0/2-8/2-8 Fiberglass Sill	076727
3-0/3-0/1-8 Fiberglass Sill	076728
1-8/3-0/3-0 Fiberglass Sill	076728
3-0/3-0/2-0 Fiberglass Sill	076728
2-0/3-0/3-0 Fiberglass Sill	076728
1-4/3-0/1-4 Fiberglass Sill	076726
1-6/3-0/1-6 Fiberglass Sill	076726
1-8/3-0/1-8 Fiberglass Sill	076727
2-0/3-0/2-0 Fiberglass Sill	076727
4 Wide	
2-0/2-8/2-8/2-0 Fiberglass Sill	020696
2-0/3-0/3-0/2-0 Fiberglass Sill	020696

Note: Parts drawings not to scale.

Continued on next page

Classic Aluminum Wood Inswing Patio Doors Replacement Parts



Sills, Thresholds and Stops

Continued from previous page

Item #4

6-9/16 Fiberglass Sill (Effective 2/19/96) Part No.

Single Wide

1-4 Fiberglass Sill	076730
1-6 Fiberglass Sill	076730
1-8 Fiberglass Sill	076730
2-0 Fiberglass Sill	076730
2-6 Fiberglass Sill	076731
2-8 Fiberglass Sill	076732
3-0 Fiberglass Sill	076733

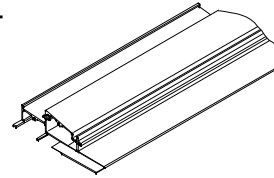

2 Wide

2-0/2-0 Fiberglass Sill	076734
2-6/2-6 Fiberglass Sill	076735
2-8/2-8 Fiberglass Sill	076736
3-0/3-0 Fiberglass Sill	076737
3-0/1-4 Fiberglass Sill	076735
1-4/3-0 Fiberglass Sill	076735
3-0/1-6 Fiberglass Sill	076735
1-6/3-0 Fiberglass Sill	076735
3-0/1-8 Fiberglass Sill	076735
1-8/3-0 Fiberglass Sill	076735
3-0/2-0 Fiberglass Sill	076736
2-0/3-0 Fiberglass Sill	076736

3 Wide

2-0/2-0/2-0 Fiberglass Sill	076737
2-6/2-6/2-6 Fiberglass Sill	076738
2-8/2-8/2-8 Fiberglass Sill	076739
3-0/3-0/3-0 Fiberglass Sill	076740
2-6/2-6/1-8 Fiberglass Sill	076738
1-8/2-6/2-6 Fiberglass Sill	076738
2-6/2-6/2-0 Fiberglass Sill	076738
2-0/2-6/2-6 Fiberglass Sill	076738
2-8/2-8/1-8 Fiberglass Sill	076738
1-8/2-8/2-8 Fiberglass Sill	076738
2-8/2-8/2-0 Fiberglass Sill	076738
2-0/2-8/2-8 Fiberglass Sill	076738
3-0/3-0/1-8 Fiberglass Sill	076739
1-8/3-0/3-0 Fiberglass Sill	076739
3-0/3-0/2-0 Fiberglass Sill	076739
2-0/3-0/3-0 Fiberglass Sill	076739
1-4/3-0/1-4 Fiberglass Sill	076737
1-6/3-0/1-6 Fiberglass Sill	076737
1-8/3-0/1-8 Fiberglass Sill	076738
2-0/3-0/2-0 Fiberglass Sill	076738

4 Wide

2-0/2-8/2-8/2-0 Fiberglass Sill	020697
2-0/3-0/3-0/2-0 Fiberglass Sill	020697

Note: Parts drawings not to scale.

Sills, Thresholds and Stops

Dual Inswing Fiberglass Sill (Not Shown)	Hinging	Part No.
3 Pt. Lock with 2 Pt. Shoot Bolt (Astragal) (Category II)		
RETRO Astragal	Active/Semi-Active CD 25	210902
6-8 Astragal	Active/Semi-Active CD 25	207521
6-10 Astragal	Active/Semi-Active CD 25	210904
7-2 Astragal	Active/Semi-Active CD 25	210906
8-0 Astragal	Active/Semi-Active CD 25	207523
RETRO Astragal	Semi-Active/Active CD 43	210903
6-8 Astragal	Semi-Active/Active CD 43	207522
6-10 Astragal	Semi-Active/Active CD 43	210905
7-2 Astragal	Semi-Active/Active CD 43	210907
8-0 Astragal	Semi-Active/Active CD 43	207524
3 Pt. Lock (Astragal) (Category III)		
RETRO Astragal	Active/Semi-Active CD 25	210908
6-8 Astragal	Active/Semi-Active CD 25	204708
6-10 Astragal	Active/Semi-Active CD 25	210910
7-2 Astragal	Active/Semi-Active CD 25	210912
8-0 Astragal	Active/Semi-Active CD 25	204713
RETRO Astragal	Semi-Active/Active CD 43	210909
6-8 Astragal	Semi-Active/Active CD 43	204843
6-10 Astragal	Semi-Active/Active CD 43	210911
7-2 Astragal	Semi-Active/Active CD 43	210913
8-0 Astragal	Semi-Active/Active CD 43	204844

Item #7 N/A

Adjustable Oak Threshold (For replacement prior to 5/16/94)	Part No.
N/A	N/A

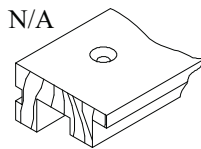

Non-Adjustable Oak Threshold (Effective 5/16/94) (Not Shown)	Part No.
2-0 Non-Adjustable Oak Threshold	206172
2-6 Non-Adjustable Oak Threshold	204552
2-8 Non-Adjustable Oak Threshold	204553
3-0 Non-Adjustable Oak Threshold	204554

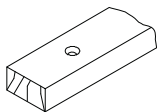

3 Panel Door only Center Screen Stop (Not Shown) (For replacement only)	Part No.		
	Bronze	White	Sand
RETRO Center Screen Stop	019561	019562	019563
6-8 Center Screen Stop	018178	018177	018186
6-10 Center Screen Stop	019564	019565	019569
7-2 Center Screen Stop	019570	019571	019572
8-0 Center Screen Stop	076669	076668	076670
Center Screen Stop	020629	020630	020631

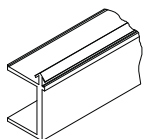

Note: Parts drawings not to scale.

Classic Aluminum Wood Inswing Patio Doors Replacement Parts



Sills, Thresholds and Stops

Item #11

Astragal (Mull) Jamb
Aluminum Cap
Without Kerf

Part No.

	Egg-shell	Bronze	White	Sand	Green	Brick Red
RETRO Astragal Cap	019613	019609	019611	019610	019612	019614
6-8 Astragal Cap	076749	076741	076745	076743	076747	076751
6-10 Astragal Cap	019620	019616	019618	019617	019619	019621
7-2 Astragal Cap	019626	019622	019624	019623	019625	019627
8-0 Astragal Cap	076750	076742	076746	076744	076748	076752
Astragal Cap	072776	014501	014500	015577	032104	072948

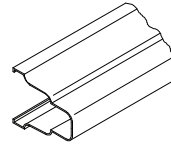

Item #11

Astragal (Mull) Jamb Cap
With Screen Channel

Part No.

	Egg-shell	Bronze	White	Sand	Green	Brick Red
RETRO Astragal Cap - Right	019632	019630	019629	019631	019628	019633
RETRO Astragal Cap - Left	019638	019636	019635	019637	019634	019639
6-8 Astragal Cap - Right	076461	076757	076755	076759	076753	076763
6-8 Astragal Cap - Left	076762	076758	076756	076760	076754	076764
6-10 Astragal Cap - Right	019643	019778	019641	019642	019640	019644
6-10 Astragal Cap - Left	019651	019647	019646	019648	019645	019652
7-2 Astragal Cap - Right	019657	019655	019654	019656	019653	019658
7-2 Astragal Cap - Left	019663	019661	019660	019662	019659	019664
8-0 Astragal Cap - Right	019669	019667	019666	019668	019665	019670
8-0 Astragal Cap - Left	019675	019673	019672	019674	019671	019676
Astragal Cap	072774	037239	037238	037240	037241	072946

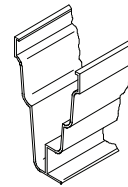

Left

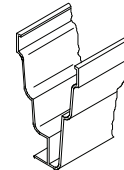

Right

Item #12

Astragal Mullion Cap

Part No.

RETRO Mullion Cap	210897
6-8 Mullion Cap	209410
6-10 Mullion Cap	210892
7-2 Mullion Cap	210899
8-0 Mullion Cap	209411

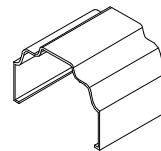

Item #13

Dual Astragal Cap

Part No.

RETRO Astragal Cap	210926
6-8 Astragal Cap	209414
6-10 Astragal Cap	210927
7-2 Astragal Cap	210928
8-0 Astragal Cap	209415

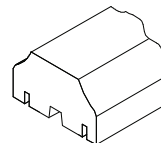

Item #36

Hingside Tongue Adj.
Astragal (McIntyre Hinge)
For Inswing Fiberglass Sill

Part No.

	Hinging	Left	Right
RETRO Astragal	Left CD 3 Right CD 2	210914	210915
6-8 Astragal	Left CD 3 Right CD 2	209396	209397
6-10 Astragal	Left CD 3 Right CD 2	210916	210917
7-2 Astragal	Left CD 3 Right CD 2	210918	210919
8-0 Astragal	Left CD 3 Right CD 2	209400	209401

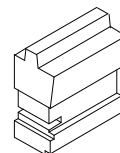

Note: Parts drawings not to scale.

Sills, Thresholds and Stops

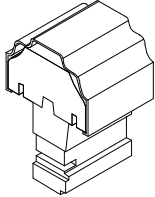

Items #12, 13, & 36	Egg-shell	Part No.					Brick Red
		Bronze	White	Sand	Green		
Astragal Mull Jamb							
Adjustable Stationary/Stationary - No Kerf							
RETRO Mull Jamb	606338	606312	606286	606299	606325	606351	
6-8 Mull Jamb	604386	601580	601581	601582	603134	604653	
6-10 Mull Jamb	606434	606408	606382	606395	606421	606447	
7-2 Mull Jamb	606520	606478	606460	606469	606487	606529	
8-0 Mull Jamb	604516	602198	602197	602199	603209	604666	
Adjustable Stationary/Stationary - Left							
RETRO Mull Jamb	606339	6069313	606287	606300	606326	606352	
6-8 Mull Jamb	604387	601583	601584	601585	603139	604654	
6-10 Mull Jamb	606435	606409	606383	606396	606422	606448	
7-2 Mull Jamb	606521	606479	606461	606470	606488	606530	
8-0 Mull Jamb	606726	606720	606718	606722	606724	606728	
Adjustable Stationary/Stationary - Right							
RETRO Mull Jamb	606340	606314	606288	606301	606327	606353	
6-8 Mull Jamb	604388	601583	601584	601585	603448	604655	
6-10 Mull Jamb	606436	606410	606384	603397	606423	606449	
7-2 Mull Jamb	606522	606480	606462	606471	606489	606531	
8-0 Mull Jamb	606727	606721	606719	606723	606725	606729	
Stationary/Adjustable Hinge - No Kerf							
RETRO Mull Jamb	606341	606315	606289	606302	606328	606354	
6-8 Mull Jamb	604389	601586	601587	601588	603135	604656	
6-10 Mull Jamb	606437	606411	606385	606398	606424	606450	
7-2 Mull Jamb	606523	606481	606463	606472	606490	606532	
8-0 Mull Jamb	604514	602201	602200	602202	603212	604570	
Adjustable Hinge/Stationary - No Kerf							
RETRO Mull Jamb	606342	606316	606290	606303	606329	606355	
6-8 Mull Jamb	604390	601589	601590	601591	603136	604657	
6-10 Mull Jamb	606438	606412	606386	606399	606425	606451	
7-2 Mull Jamb	606524	606482	606464	606473	606491	606533	
8-0 Mull Jamb	604515	602204	602203	606205	603213	604573	
Stationary/Adjustable Lock - No Kerf							
RETRO Mull Jamb	606343	606317	606291	606304	606330	606356	
6-8 Mull Jamb	604391	601592	601593	601594	603137	604658	
6-10 Mull Jamb	606439	606413	606387	606400	606426	606452	
7-2 Mull Jamb	606525	606483	606465	606474	606492	606534	
8-0 Mull Jamb	604517	602207	606206	602208	603210	604667	
Adjustable Lock/Stationary - No Kerf							
RETRO Mull Jamb	606344	606318	606292	606305	606331	606357	
6-8 Mull Jamb	604392	601595	601596	601597	603138	604659	
6-10 Mull Jamb	606440	606414	606388	606401	606427	606453	
7-2 Mull Jamb	606526	606484	606466	606475	606493	606535	
8-0 Mull Jamb	604518	602210	606209	602211	603211	604668	
Adjustable Lock/Stationary - Right							
RETRO Mull Jamb	606345	606319	606293	606306	606332	606358	
6-8 Mull Jamb	604393	601598	601599	601600	603141	604660	
6-10 Mull Jamb	606441	606415	606389	606402	606428	606454	
7-2 Mull Jamb	606527	606485	606467	606476	606494	606536	
8-0 Mull Jamb	604522	606894	606892	606893	603208	604522	
Adjustable Lock/Stationary - Left							
RETRO Mull Jamb	606346	606320	606294	606307	606333	606359	
6-8 Mull Jamb	604394	601601	601602	601603	603140	604661	
6-10 Mull Jamb	606442	606416	606390	606403	606429	606455	
7-2 Mull Jamb	606528	606486	606468	606477	606495	606537	
8-0 Mull Jamb	604251	606897	606895	606896	603207	604521	

Note: Parts drawings not to scale.

Classic Aluminum Wood Inswing Patio Doors Replacement Parts



Glass Bead

Item #21

Wood Interior Glazing Bead	Part No.
L/F 3/4" Glass Bead	203759
45° Cut as Follows:	
14" Glass Width 14-7/16"	206454
20" Glass Width 20-7/16"	203788
22" Glass Width 22-7/16"	203789
26" Glass Width 26-7/16"	203790
28" Glass Width 28-7/16"	211382
42" Glass Width 42-7/16"	211380
70" Glass Height 70-9/32"	203791
74" Glass Height 74-7/16"	211383
82-1/4" Glass Height 82-17/32"	205969
85" Glass Height 85-7/16"	211381
L/F 3/4" Glass Bead	211454
45° Cut as Follows:	
28" Glass Width 28-13/16"	211386
42" Glass Width 42-13/16"	211387
74" Glass Width 74-13/16"	211385
85" Glass Width 85-13/16"	211384

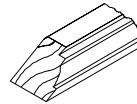

Glass bead uses 1/16" x 11/16" tape between the interior face of the glass and the wood glass bead, and 1/16" x 3/16" tape between the exterior face of the glass and the aluminum with silicone caulk along the perimeter.

L/F 1/16" x 11/16" Black Foam Glaze Tape (200' per Roll)	018895
L/F 1/16" x 3/16" Black Foam Glaze Tape (150' per Roll)	010200
1/16" x 11/16" x 50' Black Foam Glaze Tape	011833
1/16" x 3/16" x 50' Black Foam Glaze Tape	011834
3/32" Glass Setting Block	019299

Note: Parts drawings not to scale.

Glass

Item #22 Glass

(Used in windows manufactured after February 19, 2003)

Door Size	Glass Size	3/4" Low-E			
		3/4" Insulating	3/4" Standard Low-E	Climate Control	Super Sun Blocker
		Part No.	Part No.		
1-4 x Retro	6 x 69-1/4	517958	520919		
1-6 x Retro	8 x 69-1/4	517959	520920		
1-8 x Retro	10 x 69-1/4	517960	520921		
2-0 x Retro	14 x 69-1/4	517961	520922		
2-6 x Retro	20 x 69-1/4	517962	520923		
2-8 x Retro	22 x 69-1/4	517963	520924		
3-0 x Retro	26 x 69-1/4	517964	520925		
1-4 x 6-8	6 x 70	517965	520926		
1-6 x 6-8	8 x 70	517966	520927		
1-8 x 6-8	10 x 70	517967	520928		
2-0 x 6-8	14 x 70	514180	514188		
2-6 x 6-8	20 x 70	511089	512868		
2-8 x 6-8	22 x 70	511471	512869		
3-0 x 6-8	26 x 70	511090	512870		
1-4 x 6-10	6 x 69-1/4	517958	520919		
1-6 x 6-10	8 x 69-1/4	517959	520920		
1-8 x 6-10	10 x 69-1/4	517960	520921		
2-0 x 6-10	14 x 69-1/4	517961	520922		
2-6 x 6-10	20 x 69-1/4	517962	520923		
2-8 x 6-10	22 x 69-1/4	517963	520924		
3-0 x 6-10	26 x 69-1/4	517964	520925		
1-4 x 7-2	6 x 73-1/8	517968	520929		
1-6 x 7-2	8 x 73-1/8	517969	520930		
1-8 x 7-2	10 x 73-1/8	517970	520931		
2-0 x 7-2	14 x 73-1/8	517971	520932		
2-6 x 7-2	20 x 73-1/8	517972	520933		
2-8 x 7-2	22 x 73-1/8	517973	520934		
3-0 x 7-2	26 x 73-1/8	517974	520935		
1-4 x 8-0	6 x 82-1/4	517975	520936		
1-6 x 8-0	8 x 82-1/4	517976	520937		
1-8 x 8-0	10 x 82-1/4	517977	520938		
2-0 x 8-0	14 x 82-1/4	514181	514189		
2-6 x 8-0	20 x 82-1/4	512476	512871		
2-8 x 8-0	22 x 82-1/4	512477	512872		
3-0 x 8-0	26 x 82-1/4	512478	512873		

* Climate Control and Super Sun Blocker do not have part numbers.

Note: All glass is tempered.

Tech Tip: Hurd recommends glass only for replacement.

Classic Aluminum Wood Inswing Patio Doors

Replacement Parts



Panel Assembly

All panels are the same price, regardless of hinging, code or color.

Door Size	Insulating	Low-E		
		Standard	Climate Control	Super Sun Blocker
1-4 x Retro				
1-6 x Retro				
1-8 x Retro				
2-0 x Retro				
2-6 x Retro				
2-8 x Retro				
3-0 x Retro				
1-4 x 6-8				
1-6 x 6-8				
1-8 x 6-8				
2-0 x 6-8				
2-6 x 6-8				
2-8 x 6-8				
3-0 x 6-8				
1-4 x 6-10				
1-6 x 6-10				
1-8 x 6-10				
2-0 x 6-10				
2-6 x 6-10				
2-8 x 6-10				
3-0 x 6-10				
1-4 x 7-2				
1-6 x 7-2				
1-8 x 7-2				
2-0 x 7-2				
2-6 x 7-2				
2-8 x 7-2				
3-0 x 7-2				
1-4 x 8-0				
1-6 x 8-0				
1-8 x 8-0				
2-0 x 8-0				
2-6 x 8-0				
2-8 x 8-0				
3-0 x 8-0				

Door Panels: Operating doors routed for hinges and bored for lockset and deadbolt (2-3/8" backset except 3-Point).

HINGE CODE: VIEW FROM OUTSIDE - DOORS ARE INSWINGING					
2-0, 2-6, 2-8 and 3-0	4-0, 5-0, 5-4 and 6-0		7-6, 8-0 and 9-0		
Code 1	Code 11	Code 21	Code 111	Code 112	Code 211
Code 2	Code 12	Code 13	Code 121	Code 113	Code 311
Code 3	Code 31		Code 131		

Screens

Item #31

Screens (Aluminum Sill)

Size	Screen Size	Bronze	White	Sand	Green
2-0	23 x 78-11/16	027515	027514	027516	032615
2-6	29 x 78-11/16	027506	027505	027507	032616
2-8	31 x 78-11/16	027509	027508	027510	032617
3-0	35 x 78-11/16	027512	027511	027513	032618
2-0 x 8-0 L	22-3/4 x 94	027536	027535	027537	032619
2-0 x 8-0 R	22-3/4 x 94	027539	027538	027540	032620
2-6 x 8-0 L	28-3/4 x 94	027518	027517	027519	032621
2-6 x 8-0 R	28-3/4 x 94	027521	027520	027522	032622
2-8 x 8-0 L	30-3/4 x 94	027524	027523	027525	032623
2-8 x 8-0 R	30-3/4 x 94	027527	027526	027528	032624
3-0 x 8-0 L	34-3/4 x 94	027530	027529	027531	032625
3-0 x 8-0 R	34-3/4 x 94	027533	027532	027534	032626

Screens (Fiberglass Sill)

Unit Size	Screen Size	Part No.						
		Eggshell	Bronze	White	Sand	Green	Brick Red	
2-0 x Retro	Single	23 x 77-5/16	016074	015992	015946	016059	016067	016081
2-6 x Retro	Single	29 x 77-5/16	016075	015993	015947	016060	016068	016082
2-8 x Retro	Single	31 x 77-5/16	016076	015994	015948	016061	016069	016083
3-0 x Retro	Single	35 x 77-5/16	016077	015996	015986	016062	016070	016084
2-0 x 6-8	Single	23 x 77-15/16	076861	076845	076841	076849	076853	076865
2-6 x 6-8	Single	29 x 77-15/16	076862	076846	076842	076850	076854	076866
2-8 x 6-8	Single	31 x 77-15/16	076863	076847	076843	076851	076855	076867
3-0 x 6-8	Single	35 x 77-15/16	076864	076848	076844	076852	076856	076868
2-0 x 6-10	Single	23 x 80-1/4	016555	016171	016164	016178	016185	016562
2-6 x 6-10	Single	29 x 80-1/4	016556	016172	016165	016179	016186	016563
2-8 x 6-10	Single	31 x 80-1/4	016557	016173	016166	016180	016550	016564
3-0 x 6-10	Single	35 x 80-1/4	016558	016174	016167	016181	016551	016565
2-0 x 7-2	Single	23 x 84-1/4	016618	016596	016646	016603	016610	016625
2-6 x 7-2	Single	29 x 84-1/4	016619	016597	016586	016604	016611	016626
2-8 x 7-2	Single	31 x 84-1/4	016620	016598	016587	016605	016612	016644
3-0 x 7-2	Single	35 x 84-1/4	016621	016599	016588	016606	016613	016645
2-0 x 8-0	Left	22-3/4 x 93-1/4	076909	076877	076869	076885	076893	076917
2-0 x 8-0	Right	22-3/4 x 93-1/4	076913	076881	076873	076889	076897	076921
2-6 x 8-0	Left	28-3/4 x 93-1/4	076910	076878	076870	076886	076894	076918
2-6 x 8-0	Right	28-3/4 x 93-1/4	076914	076882	076874	076890	076898	076922
2-8 x 8-0	Left	30-3/4 x 93-1/4	076911	076879	076871	076887	076895	076919
2-8 x 8-0	Right	30-3/4 x 93-1/4	076915	076883	076875	076891	076899	076923
3-0 x 8-0	Left	35-3/4 x 93-1/4	076912	076880	076872	076888	076896	076920
3-0 x 8-0	Right	35-3/4 x 93-1/4	076916	076884	076876	076892	076900	076924

Classic Aluminum Wood Inswing Patio Doors Replacement Parts



Handle Packages

Swing Patio Door Handle Packages (Includes Items #26 - #28)

Qty.	Description	Operating Handle Pkg.	Dummy Handle Pkg.
		Part No.	Part No.
	Contemporary Lever Antique Brass Handle Package	014448	
	Contemporary Lever Bright Brass Handle Package	014449	
	Contemporary Lever White Handle Package	024625	
	French Lever Antique Brass Handle Package	014450	
	French Lever Bright Brass Handle Package	014451	
	French Lever White Handle Package	024624	

Above packages include:

- 1 Exterior Handle
- 1 Interior Handle
- 1 Latch and Deadbolt Set - Antique Brass or
- Latch and Deadbolt Set - Bright Brass
- 1 Strike Plate Package - Antique Brass or
- Strike Plate Package - Bright Brass
 - 1 Keyed Cylinder
 - 2 Keys
- 1 Latch Strike Plate
- 1 Deadbolt Strike Plate
- 8 #7 x 5/8" Screws
- 2 #10-32 x 2-1/4" Mounting Screws
- 1 #8 x 3/8" Screw (Secures Cylinder)
- 1 Drive Rod
- 1 Instruction Sheet

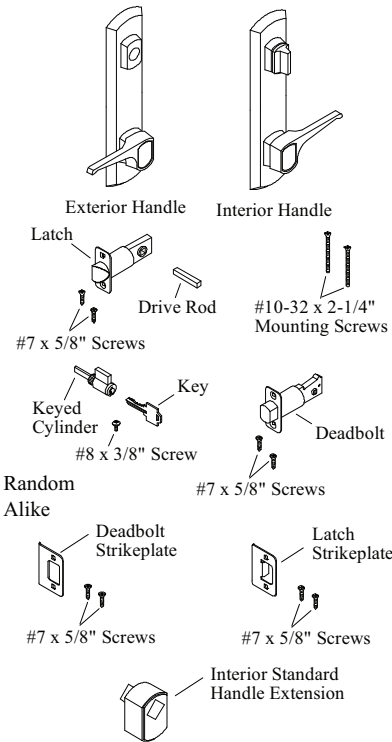

Note: Handle packages are complete and some items are also sold as individual pieces.

- 1 11/16" Interior Standard Handle Extension - Antique Brass or
- 11/16" Interior Standard Handle Extension - Bright Brass
- 037234
- 037233
- 1 Replacement Black Plastic Bushing Kit
- 025699
- 1 2" Extended Strike Plate - Antique Brass or
- 014805
- 2" Extended Strike Plate - Bright Brass
- 014806

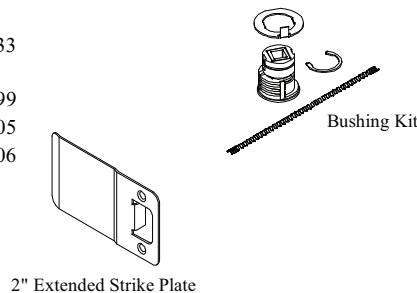

Note: Parts drawings not to scale.

3-Point Hardware Exploded View

3-POINT HARDWARE - PRIOR TO 6-1-03

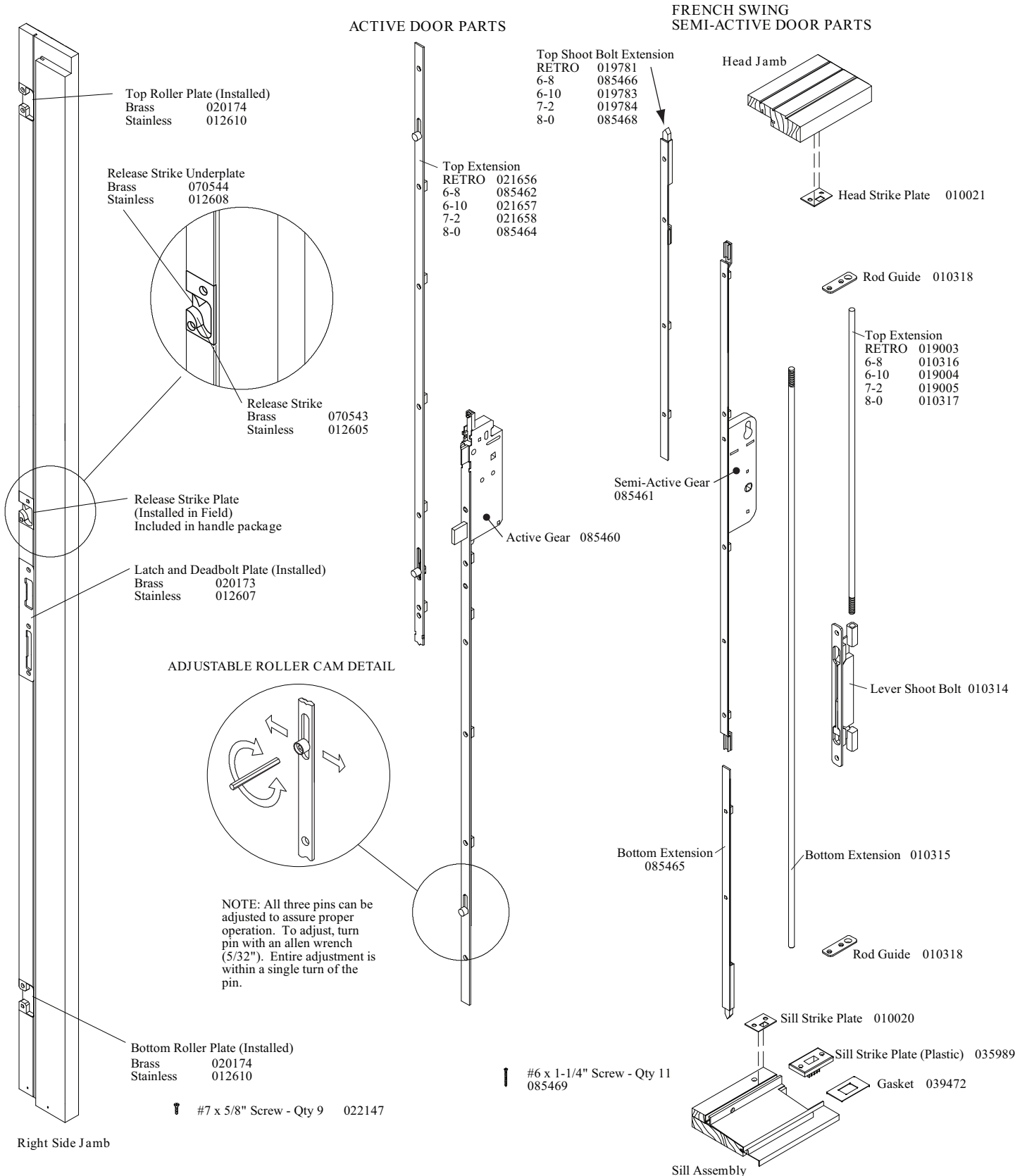

Classic Aluminum Wood Inswing Patio Doors

Classic Aluminum Wood Inswing Patio Doors Replacement Parts



3-Point Hardware Exploded View

FRENCH SWING

ACTIVE DOOR PARTS

SEMI-ACTIVE DOOR PARTS

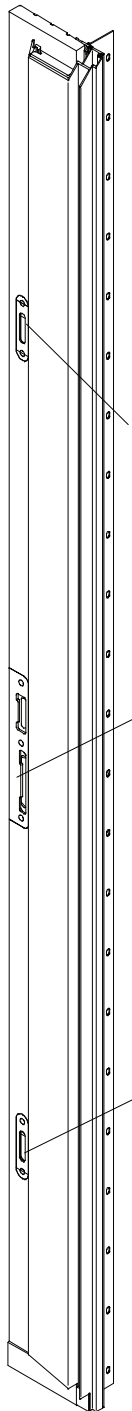

Right Side Jamb

Top Extension
RETRO 019787
6-8 019788
6-10 019789
7-2 019790
8-0 019791

#6 x 1-1/4" Screw -
Qty as Required
010607

Top Tongue Strike (Installed)
Polished Stainless Steel 090680
Brushed Stainless Steel 090679

Multi and Single-Point Latch and
Deadbolt Plate (Installed) 012607

Bottom Tongue Strike (Installed)
Polished Stainless Steel 090680
Brushed Stainless Steel 090679

#8 x 3/4" SS Screw 038684 - Used on 2Pt Shoot bolt handle

#7 x 5/8" Screw 039506 - Used on Strikes & Keepers

Active Gear 019786

Single Point Lockset 012550

Semi-Active Gear
085461

Bottom Extension
085465

Sill Weep Cover
(Not Shown)
076990

Top Extension
RETRO 019781
6-8 085466
6-10 019783
7-2 019784
8-0 085468

Head Jamb

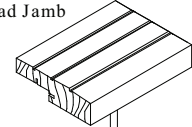

Head Strike Plate
Brushed Stainless Steel 019091
Polished Stainless Steel 092841 (For Chrome Hardware)

Rod Guide 010318



Top Shoot Bolt Extension
Stainless Steel 8 MM
RETRO 011407
6-8 011403
6-10 011405
7-2 011406
8-0 011404

Stainless Steel Mortise Lock
8 MM Thread 021693

Polished Brass Mortise Lock
w/Round Ends 010314

Bottom Extension 010315

Stainless Steel Bottom Extension 011402



Rod Guide 010318



Sill Strike Plate (Plastic) 076827



Gasket 076942

Hurd Classic Aluminum Wood Inswing Patio Doors

Replacement Parts

Handle Packages, 3-Point Hardware

Active Handle Packages

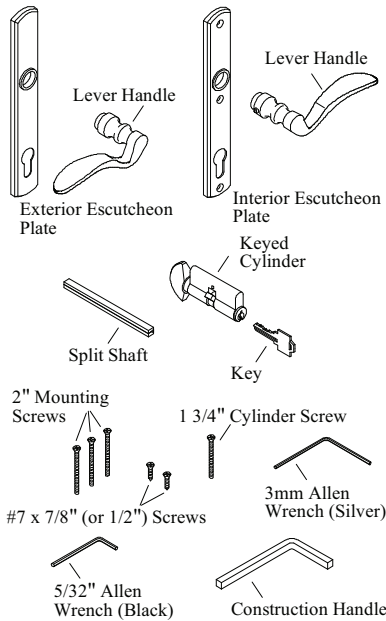

Qty.	Description	Part No.
	Antique Brass Trim and Handle Set	013328
	Bright Brass Trim and Handle Set	013252
	White Trim and Handle Set	013342
	Brushed Chrome Trim and Handle Set	085429
	Polished Chrome Trim and Handle Set	085431
	Oil Rubbed Trim and Handle Set	085427
Above packages include:		
1	Exterior Escutcheon Plate	
1	Interior Escutcheon Plate	
2	Lever Handles	
1	Split Shaft	012330
1	Keyed Cylinder	
2	Keys	
3	2" Mounting Screws - Antique Brass or	025691
	2" Mounting Screws - Bright Brass or	025690
	2" Mounting Screws - White or	070545
	2" Mounting Screws - Oil Rubbed	093963
2	#7 x 7/8" Screws	
2	#7 x 1/2" Screws	
1	1 3/4" Cylinder Screw	076106
2	M6 x 12 Brass Set Screw (for lever handles)	035870
1	3mm Allen Wrench - Silver (for handle setscrew)	
1	5/32" Allen Wrench - Black (for roller cam adjustment)	
1	Construction Handle	024096
1	Black Foam Backplate Gasket	012217
1	Instruction Sheet	

Semi-Active Handle Packages

Dummy Handle Pkg.

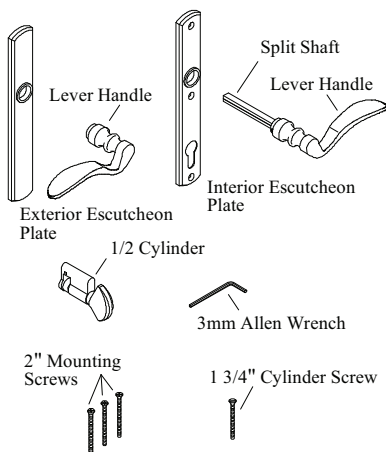

Qty.	Description	Part No.		
		Left	Right	Operator
	Antique Brass Semi-Active Trim and Handle Set	011781	011782	022436
	Bright Brass Semi-Active Trim and Handle Set	010319	010320	022435
	White Semi-Active Trim and Handle Set	011783	011784	025859
	Brushed Chrome Semi-Active Trim and Handle Set	085456	085457	085430
	Polished Chrome Semi-Active Trim and Handle Set	085458	085459	085432
	Oil Rubbed Semi-Active Trim and Handle Set	085454	085455	085428
Above packages include:				
1	Exterior Escutcheon Plate			
1	Interior Escutcheon Plate			
2	Lever Handles			
1	Split Shaft			012330
1	1/2 Cylinder			
3	2" Mounting Screws - Antique Brass or			025691
	2" Mounting Screws - Bright Brass or			025690
	2" Mounting Screws - White or			070545
	2" Mounting Screws - Oil Rubbed			093963
1	1 3/4" Cylinder Screw			076106
2	M6 x 12 Brass Set Screw (for lever handles)			035870
1	3mm Allen Wrench (for handle setscrew)			
1	Construction Handle			024096
1	Instruction Sheet			

Note: Parts drawings not to scale.

Note: Handle packages are complete and some items are also sold as individual pieces.

Classic Aluminum Wood Inswing Patio Doors Replacement Parts



Handle Packages, 3-Point Hardware

Universal Non-Handed Dummy Handle Package

Description	Part No.
Antique Brass Dummy Handle Package	011396
Bright Brass Dummy Handle Package	011397
White Dummy Handle Package	011398
Brushed Chrome Dummy Handle Package	011400
Polished Chrome Dummy Handle Package	011401
Oil Rubbed Dummy Handle Package	011399

Miscellaneous Options

Description	Part No.
Antique Brass Keyed Alike Cylinder	022428
Bright Brass Keyed Alike Cylinder	020222
White Keyed Alike Cylinder	024621
Brushed Chrome Keyed Alike Cylinder	012600
Polished Chrome Keyed Alike Cylinder	012598
Oil Rubbed Keyed Alike Cylinder	012602
Antique Brass 1/2 Cylinder	032139
Bright Brass 1/2 Cylinder	076991
White 1/2 Cylinder	032138
Brushed Chrome 1/2 Cylinder	012601
Polished Chrome 1/2 Cylinder	012599
Oil Rubbed 1/2 Cylinder	012603
1" Interior 3-Point Handle Extension - Antique Brass	037197
1" Interior 3-Point Handle Extension - Bright Brass	037196
1" Interior 3-Point Handle Extension - White	021804
1" Interior 3-Point Handle Extension - Brushed Chrome	015740
1" Interior 3-Point Handle Extension - Polished Chrome	015741
1" Interior 3-Point Handle Extension - Oil Rubbed	015742
6 1/4" Split Shaft	012220

Interior Handle Extension



Note: Parts drawings not to scale.

Miscellaneous

Items #25 - #32
Swing Patio Hardware

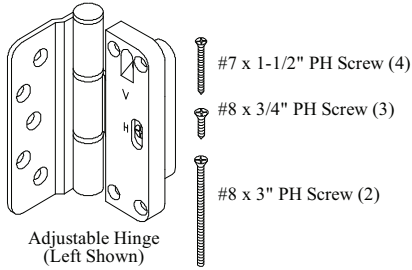

Item No.	Description	Part No.
25	Antique Brass Adjustable Hinge	
	Frame Leaf	021791
	Left Cover	021792
	Right Cover	021793
	Pin	021794
	Brite Brass Adjustable Hinge	
	Frame Leaf	010324
	Left Cover	010325
	Right Cover	010326
	Pin	010327
	Oil Rubbed Adjustable Hinge	
	Frame Leaf - No Longer Available	085439
	Left Cover - No Longer Available	085440
	Right Cover - No Longer Available	085441
Pin - No Longer Available	085442	
Brushed Chrome Adjustable Hinge	085442	
Frame Leaf	085443	
Left Cover	085444	
Right Cover	085445	
Pin	085446	
Polished Chrome Adjustable Hinge		
Frame Leaf	085447	
Left Cover	085448	
Right Cover	085449	
Pin	085450	
Gold Adjustable Hinge		
Frame Leaf	010294	
Left Cover	010295	
Right Cover	010296	
Pin	010297	
White Adjustable Hinge - Left	031239	
White Adjustable Hinge - Right	031240	
Sea Coast Adjustable Hinge - Left	032157	
Sea Coast Adjustable Hinge - Right	032158	
32	Screen Rollers - Bronze (pair)	025702
	Screen Rollers - White (pair)	025701
	Screen Rollers - Sand (pair)	025703
	Screen Roller	
Not Shown	Screen Anti-Rattle/Keeper Package (Sliding Screen only)	025692
	Sliding Screen Handle Package	076101

Note: Parts drawings not to scale.

Classic Aluminum Wood Inswing Patio Doors Replacement Parts



Miscellaneous

Fastener Schedule

Description	Where Used	Qty.*	Part No.
1/4-20 x 1-1/8" Threshold Screw	Adjustable oak threshold to subsill (aluminum sill).	4	016119
#8 x 1-1/4" PH FH Screw	Non-Adjustable oak threshold to subsill (aluminum sill).	4	011965
#7 x 5/8" PH FL Screw	3-Point hardware to frame.	9	022147
#8 x 1-1/4" PH FL SS Screw	3-Point hardware to panel.	11	017806
#8 x 1-1/4" PH FL SS Screw	3-Point french hardware to panels.	26	017806
#7 x 1-1/2" PH Screw - Gold	Adjustable hinge.	12	024588
#8 x 3/4" PH Screw - Gold	Adjustable hinge.	9	024589
#8 x 3" PH Screw - Gold	Adjustable hinge.	6	024590
#7 x 1-1/2" PH Screw - White	Adjustable hinge.	12	031241
#8 x 3/4" PH Screw - White	Adjustable hinge.	9	031243
#8 x 3" PH Screw - White	Adjustable hinge.	6	031242
#7 x 1-1/2" PH Screw - Chrome	Adjustable hinge.	12	038685
#8 x 3/4" PH Screw - Chrome	Adjustable hinge.	9	038684
#8 x 3" PH Screw - Chrome	Adjustable hinge.	6	038683
#7 x 1-1/2" PH Screw - Oil Rubbed	Adjustable hinge.	12	012926
#8 x 3/4" PH Screw - Oil Rubbed	Adjustable hinge.	9	012925
#8 x 3" PH Screw - Oil Rubbed	Adjustable hinge.	6	017129
#6 x 3/4" SS Screw	Head and sill (French) strike plate.	4	014798
#8 x 1-1/2" PH SS Screw	Stainless steel adjustable hinge.	27	076007

*Quantities for 6-0 x 6-8 door.

Miscellaneous

Item #20 - 23

Weatherstripping/Miscellaneous

Item No.	Description	Active Panel		Semi-Active & Stationary Panel	
		Size	Length	Size	Length
20	ADA Sill Bottom Door Sweep Lineal Foot Part# 097842 Bronze	1-0	10 5/8"	1-0	11 11/16"
		1-2	12 5/8"	1-2	13 11/16"
		1-4	14 5/8"	1-4	15 11/16"
		1-6	16 5/8"	1-6	17 11/16"
		1-8	18 5/8"	1-8	19 11/16"
		2-0	21 7/8"	2-0	21 15/16"
		2-6	27 7/8"	2-6	29 15/16"
		2-8	29 7/8"	2-8	31 15/16"
		3-0	33 7/8"	3-0	34 15/16"
		3-2	35 7/8"	3-2	36 15/16"

Item No.	Description	Part No.
23	1-4 Head Weatherstrip	015816
	1-6 Head Weatherstrip	015817
	1-8 Head Weatherstrip	015818
	2-0 Head Weatherstrip	070455
	2-6 Head Weatherstrip	070456
	2-8 Head Weatherstrip	070457
	3-0 Head Weatherstrip	070458
	4-0 Head Weatherstrip	070459
	5-0 Head Weatherstrip	070460
	5-4 Head Weatherstrip	070461
	6-0 Head Weatherstrip	070462
	7-6 Head Weatherstrip	070463
	8-0 Head Weatherstrip	070464
	9-0 Head Weatherstrip	070465
	RETRO Side Weatherstrip	015819
	6-8 Side Weatherstrip	070466
	6-10 Side Weatherstrip	015820
	7-2 Side Weatherstrip	015821
	8-0 Side Weatherstrip	070467
Not Shown	1-4 Fiberglass Sill Weatherstrip	015822
	1-6 Fiberglass Sill Weatherstrip	015910
	1-8 Fiberglass Sill Weatherstrip	015923
	2-0 Fiberglass Sill Weatherstrip	076828
	2-6 Fiberglass Sill Weatherstrip	076829
	2-8 Fiberglass Sill Weatherstrip	076830
	3-0 Fiberglass Sill Weatherstrip	076831
	4-0 Fiberglass Sill Weatherstrip	076832
	5-0 Fiberglass Sill Weatherstrip	076833
	5-4 Fiberglass Sill Weatherstrip	076834
	6-0 Fiberglass Sill Weatherstrip	076835
	7-6 Fiberglass Sill Weatherstrip	076836
	8-0 Fiberglass Sill Weatherstrip	076837
	9-0 Fiberglass Sill Weatherstrip	076838

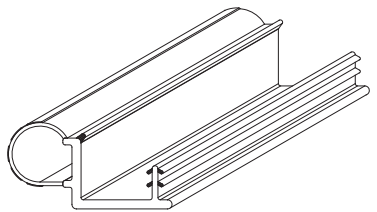
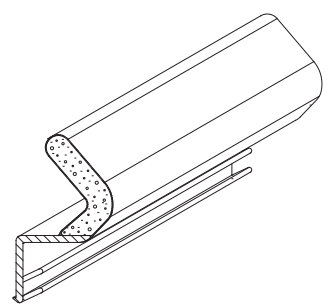
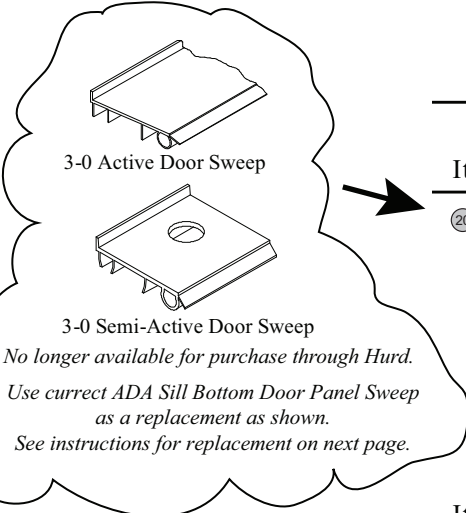

Note: Parts drawings not to scale.

Classic Swing Patio Door Panel, Bottom Sill Sweep Replace

You will need: ADA sill sweep, Utility Knife, Silicone, Roofing Nails, Gloves, Pliers & Scraper.

1. Door prep, remove door panel from door frame. Remove old sill sweep using a pair of pliers.
Prep the bottom panel surface by removing all of the old door sweep residue by using a scraper.

Use the current Hurd ADA bottom panel sill sweep to replace old classic bottom panel sill sweep. **Picture 1.**

2. Retrofit new sweep:
 - A. Using a utility knife, carefully score each side of the center barbed leg, remove and discard. **Picture 2.**
 - B. Using a utility knife, remove the top leg of the flexible weather-strip and discard. **Picture 2.**
3. Run 1/4" Ø beads of silicone along the backside of the sweep, **Picture 4.**
4. Apply the sill sweep to the bottom of the door panel, **Picture 4.**
5. Apply a row of roofing nails, staggered along the full length, along the middle of the sweep, **Picture 4.**

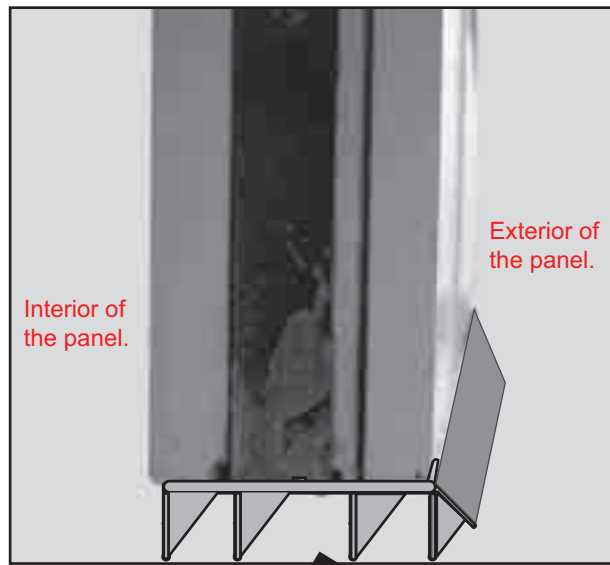
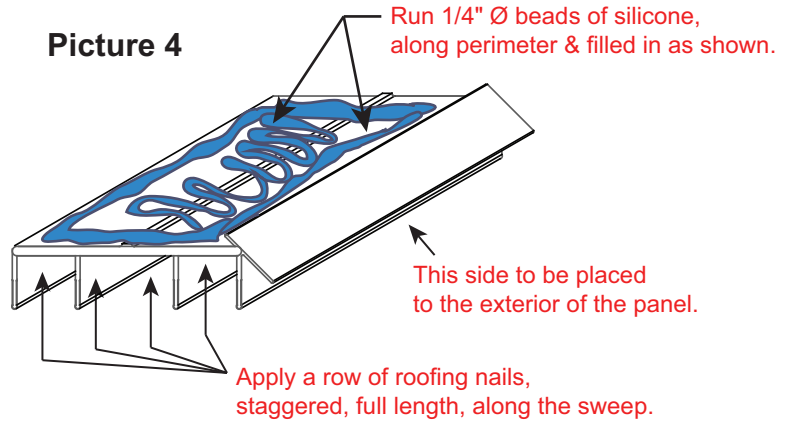
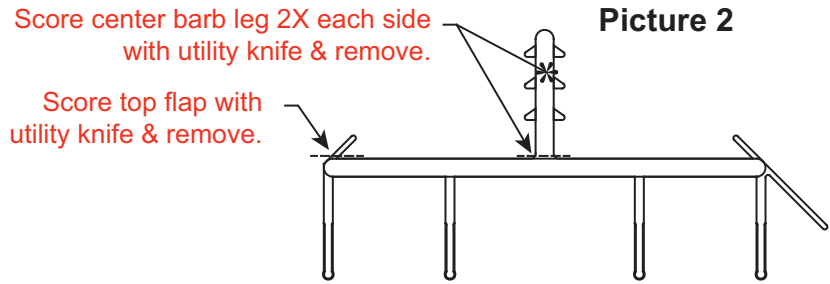
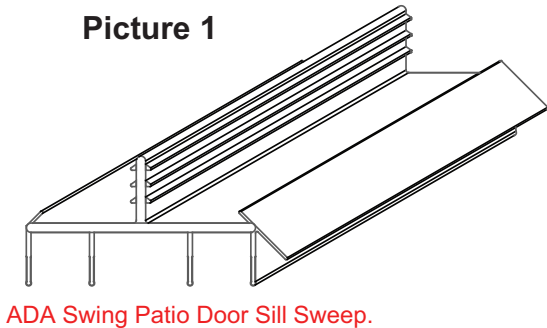

Classic Aluminum Wood Inswing Patio Doors Replacement Parts



Miscellaneous

Items #24 - #30

Weatherstripping/Miscellaneous

Item No.	Description	Where Used	Part No.
24	L/F Weatherstrip	Head Jamb, Lockside Jamb and Lock Mullion	017676
	2-0 Weatherstrip	Head Jamb (Operator Side)	025972
	2-6 Weatherstrip	Head Jamb (Operator Side)	018152
	2-8 Weatherstrip	Head Jamb (Operator Side)	018153
	3-0 Weatherstrip	Head Jamb (Operator Side)	018154
	6-8 Weatherstrip	Latch Side Jamb (Top and Bottom Section)	018173
	6-8 Leaf Weatherstrip	Latch Side Jamb (Middle Section)	018932
	Note: 30° Angle cut on head jamb weatherstrip only. Side Weatherstrip is cut square.		
	L/F Sliding Screen Pile	Channel in Screen Frame	035027
30	1-4 Head Nailing Fin		016720
	1-6 Head Nailing Fin		016721
	1-8 Head Nailing Fin		016722
	2-0 Head Nailing Fin		029101
	2-6 Head Nailing Fin		029102
	2-8 Head Nailing Fin		029103
	3-0 Head Nailing Fin		029104
	4-0 Head Nailing Fin		029105
	5-0 Head Nailing Fin		029106
	5-4 Head Nailing Fin		029107
	6-0 Head Nailing Fin		029108
	7-6 Head Nailing Fin		029109
	8-0 Head Nailing Fin		029110
	9-0 Head Nailing Fin		029111
	RETRO Folding Nailing Fin		016723
	6-8 Folding Nailing Fin		029112
	6-10 Folding Nailing Fin		016724
	7-2 Folding Nailing Fin		016725
	8-0 Folding Nailing Fin		029113

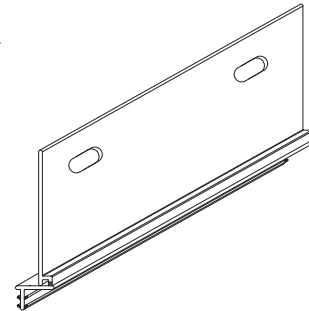
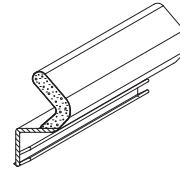







Note: Parts drawings not to scale.

Continued on next page

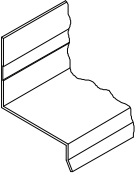
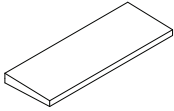
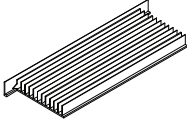
Miscellaneous

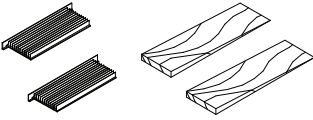
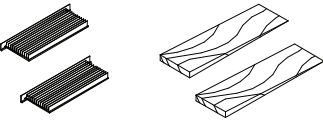
Continued from previous page

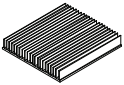
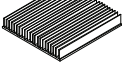
Weatherstripping/Miscellaneous

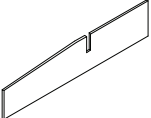
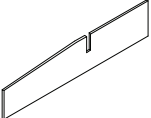
Item No.	Description	Where Used	Part No.
	Not Shown L/F Aluminum Drip Cap - White		015000
	L/F Aluminum Drip Cap - Eggshell		072798
	L/F Aluminum Drip Cap - Bronze		015001
	L/F Aluminum Drip Cap - Sand		015542
	L/F Aluminum Drip Cap - Green		032031
	L/F Aluminum Drip Cap - Brick Red		072970
	L/F Folding Nailing Fin (Head and Side)		024194
	Not Shown 3" Neoprene Tapered Shim	Stationary Panel and Frame	014652
	Not Shown Finned Corner Seal		022446
	Not Shown French Astragal Seal		035035
 <p>Finned Corner Seals Hardware Shims</p>	Not Shown Corner Seal Package Includes: 2 Finned Corner Seals 2 Hardware Shims 1 Instruction Sheet		024260
 <p>Finned Corner Seals Hardware Shims</p>	Not Shown Corner Seal/Anchor Package Includes: 2 Finned Corner Seals 2 Hardware Shims 4 #8 x 3" Screws 1 Instruction Sheet		024261
 <p>#8 x 3" PH Screws</p>			
	Not Shown 2" x 3" French Door Astragal Pad Package		011807
	Not Shown "L" French Door Astragal Seal - Top End		021721
	Not Shown End Cap		021720
	Not Shown Side Jamb Foam Gasket - Left		071884
	Not Shown Side Jamb Foam Gasket - Right		071885
	Not Shown "Rovel" Aluminum Sill Screen Track		014312

Note: Parts drawings not to scale.

Classic Aluminum Wood Inswing Patio Doors Replacement Parts



Elevations

INSWING DOOR = ISD
STANDARD = S
FRENCH = DUAL = D

ALUMINUM WOOD = ALWD
PRIMED NATURAL WOOD = WDWD
FRAME WIDTH = W

FIXED = F
RIGHT = R
LEFT = L

ACTIVE = A
SEMI-ACTIVE = S

EX.- ALWD ISD1W3LITED
 DUAL
 3 LITE(2-0/2-0/2-0 ECT.)
 1 WIDE
 INSWING DOOR
 ALUMINUM WOOD

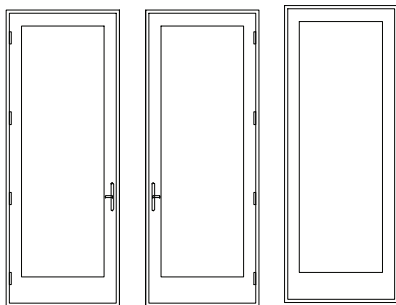

ISD1W1LITES

L R F

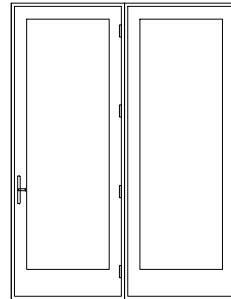

ISD1W2LITES

R F

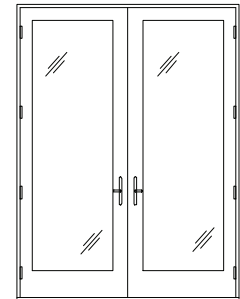

ISD1W2LITED

A OR S
S OR A

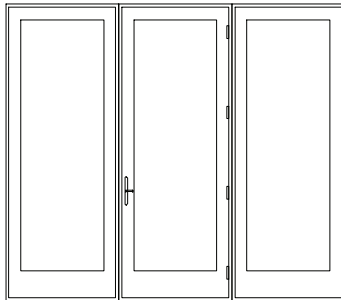

ISD1W3LITES

F R F

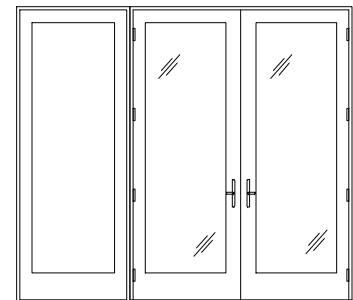

ISD1W3LITED

F A OR S
S OR A



ISD1W4LITES

F F R F

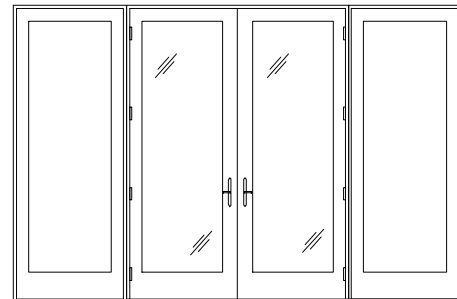

ISD1W4LITED

F A OR S F
F S OR A F

Elevations

For Classic Clad Inswing Replacement Panels: Please note that Panels will be replaced with the Energy Saver Clad panels.

For ordering:

- Stationary & Active panels, Subtract 1/8" from the existing Classic panel *width* and 1/8" from the *height* of existing Classic panel.

		WOOD							
UNIT SIZE		18 1/4	20 1/4	22 1/4	26 1/4	32 1/4	34 1/4	38 1/4	
ROUGH OPENING		16 1/4	18 1/4	20 1/4	24 1/4	30 1/4	32 1/4	36 1/4	
FRAME SIZE		15 3/4	17 3/4	19 3/4	23 3/4	29 3/4	31 3/4	35 3/4	
SCREEN SIZE		N/A	N/A	N/A	23	29	31	35	
PANEL SIZE		14	16	18	22	28	30	34	
GLASS SIZE		6	8	10	14	20	22	26	
		CLAD							
UNIT SIZE		15 3/4	17 3/4	19 3/4	23 3/4	29 3/4	31 3/4	35 3/4	
ROUGH OPENING		16 1/4	18 1/4	20 1/4	24 1/4	30 1/4	32 1/4	36 1/4	
FRAME SIZE		15 3/4	17 3/4	19 3/4	23 3/4	29 3/4	31 3/4	35 3/4	
SCREEN SIZE		N/A	N/A	N/A	23	29	31	35	
PANEL SIZE		14	16	18	22	28	30	34	
GLASS SIZE		6	8	10	14	20	22	26	

		1-4	1-6	1-8	2-0	2-6	2-8	3-0				
UNIT S 80 3/4 RO 80 FS 79 1/2 SCRNS 77 5/16 PNL S 77 1/8 GLS S 69 1/4	RETRO F F F F L R F L R F L R F L R											
		UNIT S 83 3/4 RO 83 FS 82 1/2 SCRNS 80 1/4 PNL S 80 1/8 GLS S 69 1/4	6-10 									
				UNIT S 87 5/8 RO 86 7/8 FS 86 3/8 SCRNS 84 1/8 PNL S 84 GLS S 73 1/8	7-2 							
						UNIT S 96 3/4 RO 96 FS 95 1/2 SCRNS 93 1/4 PNL S 93 1/8 GLS S 82 1/4	8-0 					
WOOD	CLAD											

Classic Aluminum Wood Inswing Patio Doors Replacement Parts



Elevations

For Classic Clad Inswing Replacement Panels: Please note that Panels will be replaced with the Energy Saver Clad panels.

For ordering:

- Stationary & Active panels, Subtract 1/8" from the existing Classic panel *width* and 1/8" from the *height* of existing Classic panel.

		WOOD					
		UNIT SIZE	49 3/8	61 3/8	65 3/8	73 3/8	
		ROUGH OPENING	47 3/8	59 3/8	63 3/8	71 3/8	
		FRAME SIZE	46 7/8	58 7/8	62 7/8	70 7/8	
		SCREEN SIZE	23	29	31	35	
		PANEL SIZE	22	28	30	34	
		GLASS SIZE	14	20	22	26	
		CLAD		46 7/8	58 7/8	62 7/8	70 7/8
		ROUGH OPENING	47 3/8	59 3/8	63 3/8	71 3/8	
		FRAME SIZE	46 7/8	58 7/8	62 7/8	70 7/8	
		SCREEN SIZE	23	29	31	35	
		PANEL SIZE	22	28	30	34	
		GLASS SIZE	14	20	22	26	
			2-0/2-0	2-6/2-6	2-8/2-8	3-0/3-0	
			AS OR SA	AS OR SA	AS OR SA	AS OR SA	
UNIT S	80 3/4	79 1/2					RETRO
RO	80						
FS	79 1/2						
SCRN S	77 5/16	77 5/16					
PNL S	77 1/8	77 1/8					6-10
GLS S	69 1/4	69 1/4					
UNIT S	83 3/4	82 1/2					
RO	83	83					
FS	82 1/2	82 1/2					7-2
SCRN S	80 1/4	80 1/4					
PNL S	80 1/8	80 1/8					
GLS S	69 1/4	69 1/4					
UNIT S	87 5/8	86 3/8					8-0
RO	86 7/8	86 7/8					
FS	86 3/8	86 3/8					
SCRN S	84 1/8	84 1/8					
PNL S	84	84					WOOD
GLS S	73 1/8	73 1/8					
UNIT S	96 3/4	95 1/2					
RO	96	96					
FS	95 1/2	95 1/2					CLAD
SCRN S	93 1/4	93 1/4					
PNL S	93 1/8	93 1/8					
GLS S	82 1/4	82 1/4					

Hurd Classic Aluminum Wood Inswing Patio Doors Replacement Parts

Elevations

For Classic Clad Inswing Replacement Panels: Please note that Panels will be replaced with the Energy Saver Clad panels.

For ordering:

- Stationary & Active panels, Subtract 1/8" from the existing Classic panel *width* and 1/8" from the *height* of existing Classic panel to get the new Energy Saver panel width and height for ordering.

WOOD		49 3/8	61 3/8	65 3/8	73 3/8
UNIT SIZE		49 3/8	61 3/8	65 3/8	73 3/8
ROUGH OPENING		47 3/8	59 3/8	63 3/8	71 3/8
FRAME SIZE		46 7/8	58 7/8	62 7/8	70 7/8
SCREEN SIZE		23	29	31	35
PANEL SIZE		22	28	30	34
GLASS SIZE		14	20	22	26

CLAD		46 7/8	58 7/8	62 7/8	70 7/8
UNIT SIZE		46 7/8	58 7/8	62 7/8	70 7/8
ROUGH OPENING		47 3/8	59 3/8	63 3/8	71 3/8
FRAME SIZE		46 7/8	58 7/8	62 7/8	70 7/8
SCREEN SIZE		23	29	31	35
PANEL SIZE		22	28	30	34
GLASS SIZE		14	20	22	26

		2-0/2-0		2-6/2-6		2-8/2-8		3-0/3-0	
		L	F	L	F	L	F	L	F
UNIT S	80 3/4	79 1/2		79 1/2		79 1/2		79 1/2	
RO	80	80		80		80		80	
FS	79 1/2	79 1/2		79 1/2		79 1/2		79 1/2	
SCRN S	77 5/16	77 5/16		77 5/16		77 5/16		77 5/16	
PNL S	77 1/8	77 1/8		77 1/8		77 1/8		77 1/8	
GLS S	69 1/4	69 1/4		69 1/4		69 1/4		69 1/4	
RETRO									
UNIT S	83 3/4	82 1/2		82 1/2		82 1/2		82 1/2	
RO	83	83		83		83		83	
FS	82 1/2	82 1/2		82 1/2		82 1/2		82 1/2	
SCRN S	80 1/4	80 1/4		80 1/4		80 1/4		80 1/4	
PNL S	80 1/8	80 1/8		80 1/8		80 1/8		80 1/8	
GLS S	69 1/4	69 1/4		69 1/4		69 1/4		69 1/4	
6-10									
UNIT S	87 5/8	86 3/8		86 3/8		86 3/8		86 3/8	
RO	86 7/8	86 7/8		86 7/8		86 7/8		86 7/8	
FS	86 3/8	86 3/8		86 3/8		86 3/8		86 3/8	
SCRN S	84 1/8	84 1/8		84 1/8		84 1/8		84 1/8	
PNL S	84	84		84		84		84	
GLS S	73 1/8	73 1/8		73 1/8		73 1/8		73 1/8	
7-2									
UNIT S	96 3/4	95 1/2		95 1/2		95 1/2		95 1/2	
RO	96	96		96		96		96	
FS	95 1/2	95 1/2		95 1/2		95 1/2		95 1/2	
SCRN S	93 1/4	93 1/4		93 1/4		93 1/4		93 1/4	
PNL S	93 1/8	93 1/8		93 1/8		93 1/8		93 1/8	
GLS S	82 1/4	82 1/4		82 1/4		82 1/4		82 1/4	
8-0									
WOOD		CLAD							

Classic Aluminum Clad Inswing Patio Doors

Classic Aluminum Wood Inswing Patio Doors Replacement Parts



Elevations

For Classic Clad Inswing Replacement Panels: Please note that Panels will be replaced with the Energy Saver Clad panels.

For ordering:

- Stationary & Active panels, Subtract 1/8" from the existing Classic panel *width* and 1/8" from the *height* of existing Classic panel.

		WOOD							
UNIT SIZE		53 3/8	55 3/8	57 3/8	61 3/8				
ROUGH OPENING		51 3/8	53 3/8	55 3/8	59 3/8				
FRAME SIZE		50 7/8	52 7/8	54 7/8	58 7/8				
SCREEN SIZE		35	35	35	35				
PANEL SIZE		34 / 14	34 / 16	34 / 18	34 / 22				
GLASS SIZE		26 / 6	26 / 8	26 / 10	26 / 14				
		CLAD							
UNIT SIZE		50 7/8	52 7/8	54 7/8	58 7/8				
ROUGH OPENING		51 3/8	53 3/8	55 3/8	59 3/8				
FRAME SIZE		50 7/8	52 7/8	54 7/8	58 7/8				
SCREEN SIZE		35	35	35	35				
PANEL SIZE		34 / 14	34 / 16	34 / 18	34 / 22				
GLASS SIZE		26 / 6	26 / 8	26 / 10	26 / 14				
		3-0/1-4		3-0/1-6		3-0/1-8		3-0/2-0	
		L	F	L	F	L	F	L	F
UNIT S	83 3/4	82 1/2		82 1/2		82 1/2		82 1/2	
RO	83	83		83		83		83	
FS	82 1/2	82 1/2		82 1/2		82 1/2		82 1/2	
SCRN S	80 1/4	80 1/4		80 1/4		80 1/4		80 1/4	
PNL S	80 1/8	80 1/8		80 1/8		80 1/8		80 1/8	
GLS S	69 1/4	69 1/4		69 1/4		69 1/4		69 1/4	
		6-10		6-10		6-10		6-10	
UNIT S	87 5/8	86 3/8		86 3/8		86 3/8		86 3/8	
RO	86 7/8	86 7/8		86 7/8		86 7/8		86 7/8	
FS	86 3/8	86 3/8		86 3/8		86 3/8		86 3/8	
SCRN S	84 1/8	84 1/8		84 1/8		84 1/8		84 1/8	
PNL S	84	84		84		84		84	
GLS S	73 1/8	73 1/8		73 1/8		73 1/8		73 1/8	
		7-2		7-2		7-2		7-2	
UNIT S	96 3/4	95 1/2		95 1/2		95 1/2		95 1/2	
RO	96	96		96		96		96	
FS	95 1/2	95 1/2		95 1/2		95 1/2		95 1/2	
SCRN S	93 1/4	93 1/4		93 1/4		93 1/4		93 1/4	
PNL S	93 1/8	93 1/8		93 1/8		93 1/8		93 1/8	
GLS S	82 1/4	82 1/4		82 1/4		82 1/4		82 1/4	
		8-0		8-0		8-0		8-0	
WOOD		CLAD		CLAD		CLAD		CLAD	

Elevations

For Classic Clad Inswing Replacement Panels: Please note that Panels will be replaced with the Energy Saver Clad panels.

For ordering:

- Stationary & Active panels, Subtract 1/8" from the existing Classic panel *width* and 1/8" from the *height* of existing Classic panel.

		WOOD			
UNIT SIZE		68 1/2	72 1/2	76 1/2	84 1/2
ROUGH OPENING		66 1/2	70 1/2	74 1/2	82 1/2
FRAME SIZE		66	70	74	82
SCREEN SIZE		35	35	35	35
PANEL SIZE		14 / 34 / 14	16 / 34 / 16	18 / 34 / 18	22 / 34 / 22
GLASS SIZE		6 / 26 / 6	8 / 26 / 8	10 / 26 / 10	14 / 26 / 14

		CLAD			
UNIT SIZE		66	70	74	82
ROUGH OPENING		66 1/2	70 1/2	74 1/2	82 1/2
FRAME SIZE		66	70	74	82
SCREEN SIZE		35	35	35	35
PANEL SIZE		14 / 34 / 14	16 / 34 / 16	18 / 34 / 18	22 / 34 / 22
GLASS SIZE		6 / 26 / 6	8 / 26 / 8	10 / 26 / 10	14 / 26 / 14

		1-4/3-0/1-4			1-6/3-0/1-6			1-8/3-0/1-8			2-0/3-0/2-0		
		F	R	F	F	R	F	F	R	F	F	R	F
UNIT S	RO	83 3/4	82 1/2										
	FS	83	83										
	SCRN S	82 1/2	82 1/2										
	PNL S	80 1/4	80 1/4										
	GLS S	80 1/8	80 1/8										
		69 1/4	69 1/4										
		6-10											
UNIT S	RO	87 5/8	86 3/8										
	FS	86 7/8	86 7/8										
	SCRN S	86 3/8	86 3/8										
	PNL S	84 1/8	84 1/8										
	GLS S	84	84										
		73 1/8	73 1/8										
		7-2											
		WOOD CLAD											

Classic Aluminum Wood Inswing Patio Doors Replacement Parts



Elevations

For Classic Clad Inswing Replacement Panels: Please note that Panels will be replaced with the Energy Saver Clad panels.

For ordering:

- Stationary & Active panels, Subtract 1/8" from the existing Classic panel *width* and 1/8" from the *height* of existing Classic panel.

		WOOD		80 1/2		84 1/2		84 1/2	
		UNIT SIZE	80 1/2	84 1/2	84 1/2				
		ROUGH OPENING	78 1/2	82 1/2	82 1/2				
		FRAME SIZE	78	82	82				
		SCREEN SIZE	29	29	31				
		PANEL SIZE	28 / 28 / 18	28 / 28 / 22	30 / 30 / 18				
		GLASS SIZE	20 / 20 / 10	20 / 20 / 14	22 / 22 / 10				
		CLAD		78		82		82	
		UNIT SIZE	78	82	82				
		ROUGH OPENING	78 1/2	82 1/2	82 1/2				
		FRAME SIZE	78	82	82				
		SCREEN SIZE	29	29	31				
		PANEL SIZE	28 / 28 / 18	28 / 28 / 22	30 / 30 / 18				
		GLASS SIZE	20 / 20 / 10	20 / 20 / 14	22 / 22 / 10				
				2-6/2-6/1-8		2-6/2-6/2-0		2-8/2-8/1-8	
				A S A F		A S A F		A S A F	
				S A		S A		S A	
				6-10		6-10		6-10	
				7-2		7-2		7-2	
				WOOD		CLAD		WOOD	
UNIT S	83 3/4	82 1/2							
RO	83	83							
FS	82 1/2	82 1/2							
SCRN S	80 1/4	80 1/4							
PNL S	80 1/8	80 1/8							
GLS S	69 1/4	69 1/4							
UNIT S	87 5/8	86 3/8							
RO	86 7/8	86 7/8							
FS	86 3/8	86 3/8							
SCRN S	84 1/8	84 1/8							
PNL S	84	84							
GLS S	73 1/8	73 1/8							

Hurd Classic Aluminum Wood Inswing Patio Doors Replacement Parts

Windows and Doors

Elevations

For Classic Clad Inswing Replacement Panels: Please note that Panels will be replaced with the Energy Saver Clad panels.

For ordering:

- Stationary & Active panels, Subtract 1/8" from the existing Classic panel *width* and 1/8" from the *height* of existing Classic panel.

		WOOD			CLAD		
UNIT SIZE		88 1/2	92 1/2	96 1/2	86	90	94
ROUGH OPENING		86 1/2	90 1/2	94 1/2	86 1/2	90 1/2	94 1/2
FRAME SIZE		86	90	94	86	90	94
SCREEN SIZE		31	35	35	31	35	35
PANEL SIZE		30 / 30 / 22	34 / 34 / 18	34 / 34 / 22	30 / 30 / 22	34 / 34 / 18	34 / 34 / 22
GLASS SIZE		22 / 22 / 14	26 / 26 / 10	26 / 26 / 14	22 / 22 / 14	26 / 26 / 10	26 / 26 / 14

		WOOD			CLAD		
UNIT S		83 3/4	82 1/2		86 3/8	86 3/8	84 1/8
RO		83	83		86 7/8	86 7/8	84
FS		82 1/2	82 1/2		86 3/8	86 3/8	84 1/8
SCRN S		80 1/4	80 1/4		84 1/8	84 1/8	84
PNL S		80 1/8	80 1/8		84	84	84
GLS S		69 1/4	69 1/4		73 1/8	73 1/8	73 1/8

		2-8/2-8/2-0			3-0/3-0/1-8			3-0/3-0/2-0		
		A S	S A	F	A S	S A	F	A S	S A	F
6-10										
7-2										

Classic Aluminum Clad Inswing Patio Doors

Classic Aluminum Wood Inswing Patio Doors Replacement Parts



Elevations

For Classic Clad Inswing Replacement Panels: Please note that Panels will be replaced with the Energy Saver Clad panels.

For ordering:

- Stationary & Active panels, Subtract 1/8" from the existing Classic panel *width* and 1/8" from the *height* of existing Classic panel.

		WOOD		
UNIT SIZE		72 1/2	90 1/2	96 1/2
ROUGH OPENING		70 1/2	88 1/2	94 1/2
FRAME SIZE		70	88	94
SCREEN SIZE		23	29	31
PANEL SIZE		22	28	30
GLASS SIZE		14	20	22
		CLAD		
UNIT SIZE		70	88	94
ROUGH OPENING		70 1/2	88 1/2	94 1/2
FRAME SIZE		70	88	94
SCREEN SIZE		23	29	31
PANEL SIZE		22	28	30
GLASS SIZE		14	20	22
		2-0/2-0/2-0 2-6/2-6/2-6 2-8/2-8/2-8 F R F F R F F R F		
		RETRO		
		6-10		
		7-2		
		8-0		
		WOOD CLAD		
UNIT S	80 3/4	79 1/2		
RO	80	80		
FS	79 1/2	79 1/2		
SCRN S	77 5/16	77 5/16		
PNL S	77 1/8	77 1/8		
GLS S	69 1/4	69 1/4		
UNIT S	83 3/4	82 1/2		
RO	83	83		
FS	82 1/2	82 1/2		
SCRN S	80 1/4	80 1/4		
PNL S	80 1/8	80 1/8		
GLS S	69 1/4	69 1/4		
UNIT S	87 5/8	86 3/8		
RO	86 7/8	86 7/8		
FS	86 3/8	86 3/8		
SCRN S	84 1/8	84 1/8		
PNL S	84	84		
GLS S	73 1/8	73 1/8		
UNIT S	96 3/4	95 1/2		
RO	96	96		
FS	95 1/2	95 1/2		
SCRN S	93 1/4	93 1/4		
PNL S	93 1/8	93 1/8		
GLS S	82 1/4	82 1/4		

Elevations

For Classic Clad Inswing Replacement Panels: Please note that Panels will be replaced with the Energy Saver Clad panels.

For ordering:

- Stationary & Active panels, Subtract 1/8" from the existing Classic panel *width* and 1/8" from the *height* of existing Classic panel.

		WOOD		
		UNIT SIZE	108 1/2	
		ROUGH OPENING	106 1/2	
		FRAME SIZE	106	
		SCREEN SIZE	35	
		PANEL SIZE	34	
		GLASS SIZE	26	
		CLAD		
		UNIT SIZE	106	
		ROUGH OPENING	106 1/2	
		FRAME SIZE	106	
		SCREEN SIZE	35	
		PANEL SIZE	34	
		GLASS SIZE	26	
		3-0/3-0/3-0		
		F	R	F
	UNIT S	80 3/4	79 1/2	RETRO
	RO	80	80	
	FS	79 1/2	79 1/2	
	SCRN S	77 5/16	77 5/16	
	PNL S	77 1/8	77 1/8	
	GLS S	69 1/4	69 1/4	
	UNIT S	83 3/4	82 1/2	6-10
	RO	83	83	
	FS	82 1/2	82 1/2	
	SCRN S	80 1/4	80 1/4	
	PNL S	80 1/8	80 1/8	
	GLS S	69 1/4	69 1/4	
	UNIT S	87 5/8	86 3/8	7-2
	RO	86 7/8	86 7/8	
	FS	86 3/8	86 3/8	
	SCRN S	84 1/8	84 1/8	
	PNL S	84	84	
	GLS S	73 1/8	73 1/8	
	UNIT S	96 3/4	95 1/2	8-0
	RO	96	96	
	FS	95 1/2	95 1/2	
	SCRN S	93 1/4	93 1/4	
	PNL S	93 1/8	93 1/8	
	GLS S	82 1/4	82 1/4	
		WOOD	CLAD	

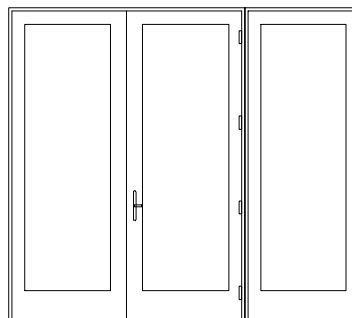
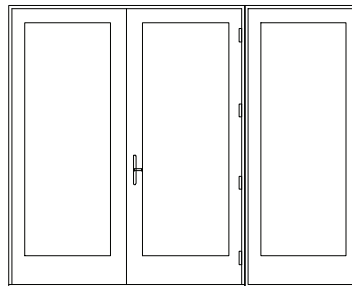
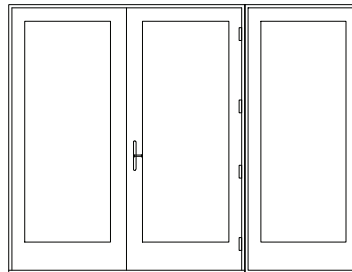
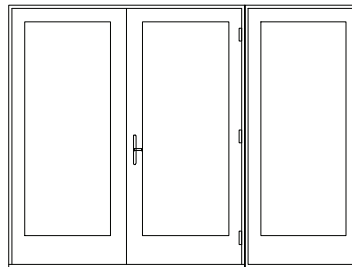

Classic Aluminum Wood Inswing Patio Doors Replacement Parts



Elevations

For Classic Clad Inswing Replacement Panels: Please note that Panels will be replaced with the Energy Saver Clad panels.

For ordering:

- Stationary & Active panels, Subtract 1/8" from the existing Classic panel *width* and 1/8" from the *height* of existing Classic panel.

		WOOD			CLAD					
UNIT SIZE		80 1/2	84 1/2	84 1/2	78	82	82			
ROUGH OPENING		78 1/2	82 1/2	82 1/2	78 1/2	82 1/2	82 1/2			
FRAME SIZE		78	82	82	78	82	82			
SCREEN SIZE		29	29	31	29	29	31			
PANEL SIZE		28 / 28 / 18	28 / 28 / 22	30 / 30 / 18	28 / 28 / 18	28 / 28 / 22	30 / 30 / 18			
GLASS SIZE		20 / 20 / 10	20 / 20 / 14	22 / 22 / 10	20 / 20 / 10	20 / 20 / 14	22 / 22 / 10			
		2-6/2-6/1-8			2-6/2-6/2-0			2-8/2-8/1-8		
		F	R	F	F	R	F	F	R	F
		6-10			6-10			6-10		
UNIT S	83 3/4	82 1/2								
RO	83	83								
FS	82 1/2	82 1/2								
SCRN S	80 1/4	80 1/4								
PNL S	80 1/8	80 1/8								
GLS S	69 1/4	69 1/4								
		2-6/2-6/1-8			2-6/2-6/2-0			2-8/2-8/1-8		
		F	R	F	F	R	F	F	R	F
		7-2			7-2			7-2		
UNIT S	87 5/8	86 3/8								
RO	86 7/8	86 7/8								
FS	86 3/8	86 3/8								
SCRN S	84 1/8	84 1/8								
PNL S	84	84								
GLS S	73 1/8	73 1/8								
		WOOD			CLAD					

Hurd Classic Aluminum Wood Inswing Patio Doors Replacement Parts

Windows and Doors

Elevations

For Classic Clad Inswing Replacement Panels: Please note that Panels will be replaced with the Energy Saver Clad panels.

For ordering:

- Stationary & Active panels, Subtract 1/8" from the existing Classic panel *width* and 1/8" from the *height* of existing Classic panel.

		WOOD		
UNIT SIZE		88 1/2	92 1/2	96 1/2
ROUGH OPENING		86 1/2	90 1/2	94 1/2
FRAME SIZE		86	90	94
SCREEN SIZE		31	35	35
PANEL SIZE		30 / 30 / 22	34 / 34 / 18	34 / 34 / 22
GLASS SIZE		22 / 22 / 14	26 / 26 / 10	26 / 26 / 14
		CLAD		
UNIT SIZE		86	90	94
ROUGH OPENING		86 1/2	90 1/2	94 1/2
FRAME SIZE		86	90	94
SCREEN SIZE		31	35	35
PANEL SIZE		30 / 30 / 22	34 / 34 / 18	34 / 34 / 22
GLASS SIZE		22 / 22 / 14	26 / 26 / 10	26 / 26 / 14
		<div style="display: flex; justify-content: space-around;"> 2-8/2-8/2-0 3-0/3-0/1-8 3-0/3-0/2-0 </div>		
		<div style="display: flex; justify-content: space-around;"> F R F F R F F R F </div>		
		6-10		
		7-2		
		<div style="display: flex; justify-content: space-around;"> WOOD CLAD </div>		
		<div style="display: flex; justify-content: space-around;"> 2-8/2-8/2-0 3-0/3-0/1-8 3-0/3-0/2-0 </div>		
		<div style="display: flex; justify-content: space-around;"> F R F F R F F R F </div>		
		6-10		
		7-2		
		<div style="display: flex; justify-content: space-around;"> WOOD CLAD </div>		
		<div style="display: flex; justify-content: space-around;"> 2-8/2-8/2-0 3-0/3-0/1-8 3-0/3-0/2-0 </div>		
		<div style="display: flex; justify-content: space-around;"> F R F F R F F R F </div>		
		6-10		
		7-2		
		<div style="display: flex; justify-content: space-around;"> WOOD CLAD </div>		
		<div style="display: flex; justify-content: space-around;"> 2-8/2-8/2-0 3-0/3-0/1-8 3-0/3-0/2-0 </div>		
		<div style="display: flex; justify-content: space-around;"> F R F F R F F R F </div>		
		6-10		
		7-2		
		<div style="display: flex; justify-content: space-around;"> WOOD CLAD </div>		
		<div style="display: flex; justify-content: space-around;"> 2-8/2-8/2-0 3-0/3-0/1-8 3-0/3-0/2-0 </div>		
		<div style="display: flex; justify-content: space-around;"> F R F F R F F R F </div>		
		6-10		
		7-2		
		<div style="display: flex; justify-content: space-around;"> WOOD CLAD </div>		
		<div style="display: flex; justify-content: space-around;"> 2-8/2-8/2-0 3-0/3-0/1-8 3-0/3-0/2-0 </div>		
		<div style="display: flex; justify-content: space-around;"> F R F F R F F R F </div>		
		6-10		
		7-2		
		<div style="display: flex; justify-content: space-around;"> WOOD CLAD </div>		
		<div style="display: flex; justify-content: space-around;"> 2-8/2-8/2-0 3-0/3-0/1-8 3-0/3-0/2-0 </div>		
		<div style="display: flex; justify-content: space-around;"> F R F F R F F R F </div>		
		6-10		
		7-2		
		<div style="display: flex; justify-content: space-around;"> WOOD CLAD </div>		
		<div style="display: flex; justify-content: space-around;"> 2-8/2-8/2-0 3-0/3-0/1-8 3-0/3-0/2-0 </div>		
		<div style="display: flex; justify-content: space-around;"> F R F F R F F R F </div>		
		6-10		
		7-2		
		<div style="display: flex; justify-content: space-around;"> WOOD CLAD </div>		
		<div style="display: flex; justify-content: space-around;"> 2-8/2-8/2-0 3-0/3-0/1-8 3-0/3-0/2-0 </div>		
		<div style="display: flex; justify-content: space-around;"> F R F F R F F R F </div>		
		6-10		
		7-2		
		<div style="display: flex; justify-content: space-around;"> WOOD CLAD </div>		
		<div style="display: flex; justify-content: space-around;"> 2-8/2-8/2-0 3-0/3-0/1-8 3-0/3-0/2-0 </div>		
		<div style="display: flex; justify-content: space-around;"> F R F F R F F R F </div>		
		6-10		
		7-2		
		<div style="display: flex; justify-content: space-around;"> WOOD CLAD </div>		
		<div style="display: flex; justify-content: space-around;"> 2-8/2-8/2-0 3-0/3-0/1-8 3-0/3-0/2-0 </div>		
		<div style="display: flex; justify-content: space-around;"> F R F F R F F R F </div>		
		6-10		
		7-2		
		<div style="display: flex; justify-content: space-around;"> WOOD CLAD </div>		
		<div style="display: flex; justify-content: space-around;"> 2-8/2-8/2-0 3-0/3-0/1-8 3-0/3-0/2-0 </div>		
		<div style="display: flex; justify-content: space-around;"> F R F F R F F R F </div>		
		6-10		
		7-2		
		<div style="display: flex; justify-content: space-around;"> WOOD CLAD </div>		
		<div style="display: flex; justify-content: space-around;"> 2-8/2-8/2-0 3-0/3-0/1-8 3-0/3-0/2-0 </div>		
		<div style="display: flex; justify-content: space-around;"> F R F F R F F R F </div>		
		6-10		
		7-2		
		<div style="display: flex; justify-content: space-around;"> WOOD CLAD </div>		
		<div style="display: flex; justify-content: space-around;"> 2-8/2-8/2-0 3-0/3-0/1-8 3-0/3-0/2-0 </div>		
		<div style="display: flex; justify-content: space-around;"> F R F F R F F R F </div>		
		6-10		
		7-2		
		<div style="display: flex; justify-content: space-around;"> WOOD CLAD </div>		
		<div style="display: flex; justify-content: space-around;"> 2-8/2-8/2-0 3-0/3-0/1-8 3-0/3-0/2-0 </div>		
		<div style="display: flex; justify-content: space-around;"> F R F F R F F R F </div>		
		6-10		
		7-2		
		<div style="display: flex; justify-content: space-around;"> WOOD CLAD </div>		
		<div style="display: flex; justify-content: space-around;"> 2-8/2-8/2-0 3-0/3-0/1-8 3-0/3-0/2-0 </div>		
		<div style="display: flex; justify-content: space-around;"> F R F F R F F R F </div>		
		6-10		
		7-2		
		<div style="display: flex; justify-content: space-around;"> WOOD CLAD </div>		
		<div style="display: flex; justify-content: space-around;"> 2-8/2-8/2-0 3-0/3-0/1-8 3-0/3-0/2-0 </div>		
		<div style="display: flex; justify-content: space-around;"> F R F F R F F R F </div>		
		6-10		
		7-2		
		<div style="display: flex; justify-content: space-around;"> WOOD CLAD </div>		
		<div style="display: flex; justify-content: space-around;"> 2-8/2-8/2-0 3-0/3-0/1-8 3-0/3-0/2-0 </div>		
		<div style="display: flex; justify-content: space-around;"> F R F F R F F R F </div>		
		6-10		
		7-2		
		<div style="display: flex; justify-content: space-around;"> WOOD CLAD </div>		
		<div style="display: flex; justify-content: space-around;"> 2-8/2-8/2-0 3-0/3-0/1-8 3-0/3-0/2-0 </div>		
		<div style="display: flex; justify-content: space-around;"> F R F F R F F R F </div>		
		6-10		
		7-2		
		<div style="display: flex; justify-content: space-around;"> WOOD CLAD </div>		
		<div style="display: flex; justify-content: space-around;"> 2-8/2-8/2-0 3-0/3-0/1-8 3-0/3-0/2-0 </div>		
		<div style="display: flex; justify-content: space-around;"> F R F F R F F R F </div>		
		6-10		
		7-2		
		<div style="display: flex; justify-content: space-around;"> WOOD CLAD </div>		
		<div style="display: flex; justify-content: space-around;"> 2-8/2-8/2-0 3-0/3-0/1-8 3-0/3-0/2-0 </div>		
		<div style="display: flex; justify-content: space-around;"> F R F F R F F R F </div>		
		6-10		
		7-2		
		<div style="display: flex; justify-content: space-around;"> WOOD CLAD </div>		
		<div style="display: flex; justify-content: space-around;"> 2-8/2-8/2-0 3-0/3-0/1-8 3-0/3-0/2-0 </div>		
		<div style="display: flex; justify-content: space-around;"> F R F F R F F R F </div>		
		6-10		
		7-2		
		<div style="display: flex; justify-content: space-around;"> WOOD CLAD </div>		
		<div style="display: flex; justify-content: space-around;"> 2-8/2-8/2-0 3-0/3-0/1-8 3-0/3-0/2-0 </div>		
		<div style="display: flex; justify-content: space-around;"> F R F F R F F R F </div>		
		6-10		
		7-2		
		<div style="display: flex; justify-content: space-around;"> WOOD CLAD </div>		
		<div style="display: flex; justify-content: space-around;"> 2-8/2-8/2-0 3-0/3-0/1-8 3-0/3-0/2-0 </div>		
		<div style="display: flex; justify-content: space-around;"> F R F F R F F R F </div>		
		6-10		
		7-2		
		<div style="display: flex; justify-content: space-around;"> WOOD CLAD </div>		
		<div style="display: flex; justify-content: space-around;"> 2-8/2-8/2-0 3-0/3-0/1-8 3-0/3-0/2-0 </div>		
		<div style="display: flex; justify-content: space-around;"> F R F F R F F R F </div>		
		6-10		
		7-2		
		<div style="display: flex; justify-content: space-around;"> WOOD CLAD </div>		
		<div style="display: flex; justify-content: space-around;"> 2-8/2-8/2-0 3-0/</div>		

Hurd Classic Aluminum Wood Inswing Patio Doors Replacement Parts

Windows and Doors

Elevations

For Classic Clad Inswing Replacement Panels: Please note that Panels will be replaced with the Energy Saver Clad panels.

For ordering:

- Stationary & Active panels, Subtract 1/8" from the existing Classic panel *width* and 1/8" from the *height* of existing Classic panel.

WOOD		111 5/8	119 5/8
UNIT SIZE			
ROUGH OPENING		109 5/8	117 5/8
FRAME SIZE		109 1/8	117 1/8
SCREEN SIZE		31	35
PANEL SIZE		22 / 30 / 30 / 22	22 / 34 / 34 / 22
GLASS SIZE		14 / 22 / 22 / 14	14 / 26 / 26 / 14

CLAD		109 1/8	117 1/8
UNIT SIZE			
ROUGH OPENING		109 5/8	117 5/8
FRAME SIZE		109 1/8	117 1/8
SCREEN SIZE		31	35
PANEL SIZE		22 / 30 / 30 / 22	22 / 34 / 34 / 22
GLASS SIZE		14 / 22 / 22 / 14	14 / 26 / 26 / 14

		2-0/2-8/2-8/2-0	2-0/3-0/3-0/2-0
		F F R F	F F R F
		6-10	
		7-2	
UNIT S	83 3/4	82 1/2	
RO	83	83	
FS	82 1/2	82 1/2	
SCRN S	80 1/4	80 1/4	
PNL S	80 1/8	80 1/8	
GLS S	69 1/4	69 1/4	
UNIT S	87 5/8	86 3/8	
RO	86 7/8	86 7/8	
FS	86 3/8	86 3/8	
SCRN S	84 1/8	84 1/8	
PNL S	84	84	
GLS S	73 1/8	73 1/8	
	WOOD	CLAD	